

The PE endorsement includes the installation and abandonment activities for this project. The PE endorsement does not include any requalification or uprate activities for the project. Requalification or uprate activities and buffer zone documentation related to the project will be endorsed later under a separate seal.



Base mapping provided by 3rd party Engineering Firm. The facilities shown on the plan must be field verified and their location is not part of the PE Seal. Utilize 811 and exposures when paralleling and crossing facilities.

**INSTALLATION ORDER NUMBER 22-0229440-00**  
**ABANDONMENT ORDER NUMBER 22-0229441-00 (LP)**  
**ABANDONMENT ORDER NUMBER 23-0221225-00(MP)**  
**R-2334 RETIREMENT (584) 23-0221465-00**

**SANDS AVE REQUAL (0001) 23-0221422-00**  
**CREEK REQUAL (0001) 23-0221464-00**  
**NEELY ST REQUAL (0001) 23-0221463-00**

**PROJECT ID 22-92164**  
**ECKERT ST REPLACEMENT**  
**JOB TYPE: AGE & CONDITION (557/558)**



**PROJECT INFORMATION**

FIELD ENGINEER/TECHNICIAN: SHIVRON SUGRIM  
 CONSTRUCTION FLL: WILLIAM TOTTEN  
 PERMITS: BELE ACRES BORO / LEET TWP  
 STATE PERMIT - SR 4036  
 ENVIRONMENTAL PERMIT  
 TCC/LOA: THE VALLEY-ROCHESTER/2231  
 COUNTY: ALLEGHENY (003)  
 TAX DISTRICT/TOWNSHIP ID: 0030218, 0030291, 0070412, 0070478  
 MAP/GRID NUMBER: 7564492K, 7564492L, 7564492O, 7564492P  
 24 HR. EMERGENCY LINE: 1-888-460-4332

**VICINITY MAP**

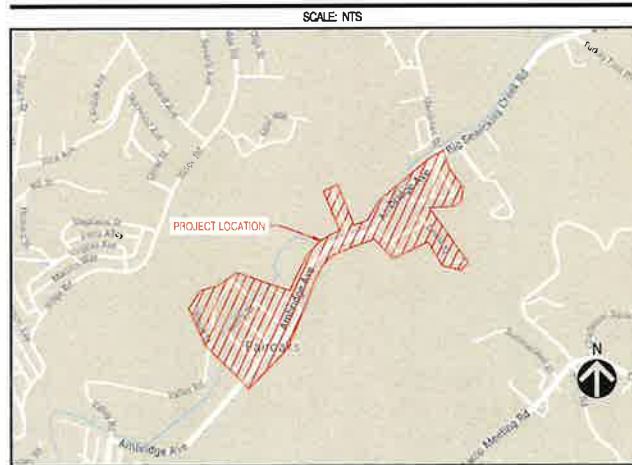

VALVES PLANNED FOR ABANDONMENT						
VALVE NO.	FACILITY ID	LOCATION DESCRIPTION	ABANDONED VALVE		DISPOSITION	
			INSERTED?	NO	VALVE REMOVED AND BELMOUNT CHANGED	VALVE REMOVED IN PLACE, BUT IS TO BE REMOVED
#		NONE				
#						
#						

\* - IF "YES," APPROVAL AND REASON ARE REQUIRED AND SHALL BE DOCUMENTED.  
 NOTE: IF VALVE COULD NOT BE LOCATED, MAKE APPLICABLE COMMENT IN ABOVE TABLE.

PROPOSED FACILITIES - SYSTEM MOP AND PRESSURE TEST DATA	
SYSTEM NUMBER	37022480
SYSTEM NAME	HIDDEN VALLEY-BELL ACRES LP
SYSTEM MOP (PSIG)	LP
SEGMENT MAOP (PSIG)	60
MINIMUM TEST PRESSURE (PSIG)	90
MAXIMUM TEST PRESSURE (PSIG)	125

PROPOSED FACILITIES - SYSTEM MOP AND PRESSURE TEST DATA	
SYSTEM NUMBER	37022357
SYSTEM NAME	AMBRIDGE - BADEN MP
SYSTEM MOP (PSIG)	47
SEGMENT MAOP (PSIG)	60
MINIMUM TEST PRESSURE (PSIG)	90
MAXIMUM TEST PRESSURE (PSIG)	125

**PROJECT DESCRIPTION**

CPA TO INSTALL MEDIUM PRESSURE GAS MAIN.  
 LP SYSTEM AND SINGLE FEED REGULATOR TO BE ABANDONED, CUSTOMERS TO BE TIED OVER TO MP SYSTEM.  
 TOTAL OF ~2,771 FT OF PL TO BE REQUALIFIED

**NOTE: BELL ACRES: FOLLOW ORDINANCE NO. 324. BOROUGH REQUIRES FULL ROADWAY WIDTH RESTORATION UNLESS OTHERWISE AGREED UPON BY BELL ACRES AND BOROUGH ENGINEER AFTER INSPECTION. MILL AND OVERLAY WITH 1.5 INCH WEARING COURSE REQUIRED.**

**SHEET INDEX**

DWG.	DESCRIPTION
T-1	TITLE SHEET
GN-1	GENERAL NOTES
BOM-1	BILL OF MATERIALS
O-1	TIE IN OVERVIEW SHEET
O-2	REQUALIFICATION OVERVIEW SHEET
L-1 - L-5	LAYOUT PLANS
D-1 - D-4	CONSTRUCTION DETAILS / REQUAL PREPARATION STEPS
ISO	R-2334 ISOMETRIC
BUFFER 1&2	REQUAL BUFFER ZONE DRAWINGS

**PROJECT SUMMARY TABLE**

PROPOSED INSTALLATION			PROPOSED ABANDONMENT		
LENGTH (FT)	SIZE (IN)	TYPE	LENGTH (FT)	SIZE (IN)	TYPE
3,958	4"	PMMP	98'	2"	BSLP
1,397	2"	PMMP	587'	3"	BSLP
			3,878'	4"	BSLP
			206'	2"	PLP
			466'	4"	PLP
			2'		UNK
5,348	TOTAL INSTALLATION (FEET)		5,236	TOTAL ABANDONMENT (FEET)	

PROPOSED GAS SERVICES				
ESTIMATED GAS SERVICES	REPLACEMENTS	TIE OVERS	TOTAL SERVICES	METER OUTS
	83	0	83	21

**MATERIAL APPROVED FOR USE ON THIS JOB ORDER IS LIMITED TO WHAT IS LISTED IN THE BILL OF MATERIALS IN THIS DRAWING.**

**ANY ADDITIONAL MATERIAL MUST BE APPROVED FOR USE BY THE P.E. RESPONSIBLE FOR THIS PROJECT.**



Know what's below.  
 Call before you dig.  
 CALL TOLL-FREE 1-800-242-1776  
 PA ONE-CALL DESIGN REQ SN#

20231042813 - ECONOMY BORO  
 20231042812 - BELLE ACRES BORO  
 20231042811 - LEET TWP  
 PRELIMINARY - 14 APRIL 2023

**PROPOSED**

**REVISIONS**

REV. #	DATE	DESCRIPTION
0	XXX	ISSUED FOR CONSTRUCTION
DESIGNED BY	Shivron Sugrim	8/1/23 412-415-8783
DRAWN BY	P. CORSGOURE	1/11/23
CHECKED BY		
AS-BUILT BY		
	NAME	DATE PHONE #

**SITE NAME:**  
**INST# 22-0229440-00**  
**ABAN# 22-0229441-00**  
**PROJECT ID# 22-92164**  
 2231 - ECKERT - REPL ID  
 AMBRIDGE, ALLEGHENY (003)

**DRAWING TITLE:**  
 TITLE SHEET

**DRAWING NO.:**  
 T-1